

Exterior Door Handle

\$125.00

BODY-0001

Cast bronze door handle with steel shank. Used on many custom bodied cars in the 1920's and 1930's including Duesenberg Model J and Derham Coachwork cars. Handle and shank are threaded to screw together. Shank should be silver brazed in place after fitting and before plating.



Handle can be supplied with shank brazed in place for an additional \$15.00 charge. For use with bezel, our part number BODY-0002.

Material: Bronze handle, steel shank;
Shank: 7/16-20 thread, 5/16 square x 3 7/8; Handle: 3.975 long, .935 wide, 1.950 high

Exterior Door Handle Bezel

\$40.00

BODY-0002

Cast bronze door handle bezel used on many custom bodied cars in the 1920's and 1930's including Duesenberg Model J and Derham Coachwork cars. Original part number 66046. For use with door handle, our part number BODY-0001.



Length: 2.100; Width: 1.200; Height: .410; Mounting holes: 1.500 centers for #10 screws

Molded Rubber Round Door Bumper

\$13.00

MISC-0022

Molded rubber round door bumper. Measures 1 1/8 OD, 9/16 high (approx.).



Cord Molded Rubber Lid Bumpers

\$16.00

COR-0002

New molded rubber lid bumpers with hole in the center for the attaching screw. These are ready to install and measure 15/16 Dia. and 9/16 h. Used on Cord Convertible Coupe. Sold as a set of four.

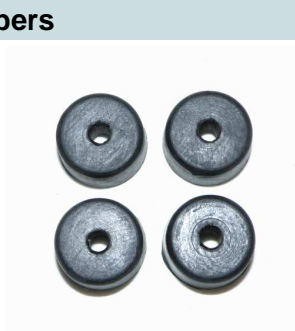

Cord 810/812 Molded Rubber Steering Column Grommets

\$32.00

COR-0001

New molded rubber grommets, ready to install. Measure 3 3/4 OD and 1 11/16 ID. Quantity of two used per car. Sold as a set of two.



Bugatti T57 Rear Axle Bumper

\$36.00

BUG-0019

New molded rubber bumper to fit Bugatti Type 57 rear axle.



Voisin 6 Cyl. Bumper End

\$325.00

V-0007

Rubber molded bumper end with steel core for use on 1934-1936 Voisin 6 cylinder. May also fit other years and models. Price includes a \$50.00 core charge to be refunded upon receipt of a usable core.



Material: Rubber & Steel; Finish: Natural; Molded rubber: approx. 3.062 x 4.125; Steel core: 1.750 x 2.000; Hole ID: .437

Packard V-12 Front Sill Plates

\$90.00

P-0072

New photo engraved sill plates to fit many Series and models of Packard V-12. These perfect reproduction sill plates have been photo-etched into .032 brass and are exact duplicates of the original Packard parts. The plates are ready to be drilled and plated. Front sill plates are 2.562 x 34.935. and will fit 1935 V-12 Convertible Sedan. Original Packard part numbers: 224317 (right) and 224318 (left).



**Packard V-12 Rear Sill Plates**

\$75.00

P-0073

New photo engraved rear sill plates to fit many Series and models of Packard V-12. These perfect reproduction sill plates have been photo-etched into .032 brass and are exact duplicates of the original Packard parts. The plates are ready to be drilled and plated. Rear plates are 1.375 x 17.187.



Rear sill plates will fit:

15th, 16th & 17th Series 7 Pass.

Touring Sedan

15th, 16th & 17th Series 7 Pass.

Touring Sedan Limo

15th, 16th & 17th Series 5 Pass. Club

Sedan

15th, 16th & 17th Series 5 Pass.

Convertible Sedan

17th Series 5 Pass. Victoria

Original Packard part numbers:
224307 (right) and 224308 (left).

Murphy Body Door Sill Plates

\$129.00

MB-0010

Door sill plate to fit all Murphy bodied cars of the 1920's and 1930's. These sill plates are an exact duplicate of the original shape, are made from .040 thick brass and measure 35 X 2 or 35 X 2 3/4". The Murphy logo is stamped into the brass in the center of the plate.



These sill plates are produced to be trimmed to fit and drilled by the purchaser. They will also need to be polished and plated by the purchaser.

Auburn Boattail Speedster Sill Plate

\$150.00

AUB-0005

Aluminum sill plate for use on Auburn Boattail Speedster. Sill plate has an etched-in design and is an exact duplicate of an original sill plate.



Material: Aluminum; Finish: Natural;
Length: 32.00; Width: 3.062;
Thickness: .052; Inner bend DIA: .557;
Width before bend: 2.00; Width after
bend: .312

Maserati Ghibli Sill Plate

\$125.00

MAS-0002

Universal aluminum sill plate for Maserati Ghibli. Fits left and right side of the car, but will need to be polished and trimmed to fit before installation. Maserati part number 115B064950.



Material: Aluminum; Finish: Natural;
Width: 1.727; Length: 36.00;
Thickness: .050

Dovetail Door Bumper Socket

\$50.00

MISC-0068

Ideal door bumper socket. New fully machined aluminum part to replace original die cast Ternstedt Mfg. Co. part. Used with a steel capped rubber bumper, this dovetail socket has four mounting holes to hold the socket to the car body, has four holes tapped for 8-32 screws to retain the cover plate and two pockets for bumpers.

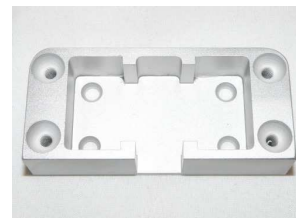

Available in two pocket sizes: 1/2" or 5/8". Outside dimensions: 3" long x 1 11/32 wide x 5/8 high. Interior dimensions: 1 1/8 x 9/16 deep.

Murphy Body Door Bumper Sockets

\$29.00

MB-0003

Murphy body door bumper sockets CNC machined from solid aluminum. Can be shortened to fit a specific application. Both sockets have .030 lip to overlap the door jams.

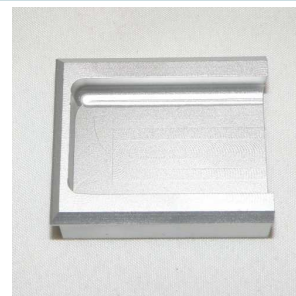

Available in two lengths:

Outside width: 1.355

Outside length: 1.719

Height: .488

Outside width: 1.355

Outside length: 1.106

Height: .488

Window Flapper Spring #1

\$8.50

MB-0001

Stainless steel spring for closing window flappers. Commonly used on Murphy bodies, this style has clock wise wind & long ends coming off on the same side. Also used by Brunn, Rollston, LeBaron and others. Measures 1.260 with a .218 OD wire. Wire thickness is .040. Ends can be trimmed and bent if needed.



**Window Flapper Spring #2**

\$8.50

MB-0002

Stainless steel spring for closing window flappers. Commonly used on Murphy bodies, this style has counter clockwise wind with long ends coming off on opposite sides. Also used by Brunn, Rollston LeBaron and others. Measures 1.130 OAL with a .218 OD wire. Wire thickness is .040. Ends can be trimmed and bent if needed.

**Window Flapper Spring #4**

\$8.50

MB-0005

Stainless steel spring for closing window flappers. Commonly used on Murphy bodies, also used by Brunn, Rollston, LeBaron and others. Measures .584 OAL with a .224 OD wire. Wire thickness is .040. Ends can be trimmed and bent if needed.

**Window Flapper Spring #3**

\$8.50

MB-0004

Stainless steel spring for closing window flappers. Commonly used on Murphy bodies, this style has clockwise wind with long ends coming off on opposite sides. Also used by Brunn, Rollston, LeBaron and others. Measures .935 OAL with a .169 OD wire. Wire thickness is .034. Ends can be trimmed and bent if needed.

**1932-33 Packard Windshield Locking Mechanism Link**

\$50.00

P-0143

Linkage for the windshield locking mechanism on 1932 and 1933 Packard. Used in adjusting the angle of the windshield and securing it in place. Packard part numbers 194987 and 194988. For use on:

1932 Standard 8509, 523, 527
1932 Deluxe 8519, 533, 537
1932 12578, 579, 583, 587
1933 Standard 8618, 619, 623, 627
1933 Super 8658, 659, 663, 667

Material: Spring steel; Finish: Natural;
Length: 6.975; Width: .675; Thickness:
.042; Hole ID: .110

**Auburn 851 852 Hood Hinge**

\$50.00

AUB-0001

Hood hinge for Auburn 851/852 hood sides. Specially made for use on Auburn, but may also fit other makes of automobiles.



Material: Steel; Pin: 3/16; Knuckle:
2.00; Open width: 1 1/4; Thickness:
.060; Length: 60"

1930-33 Cadillac Hood Rest Bracket

\$35.00

CAD-0092

Steel hood rest bracket attaching to center hinge on 1930 - 1933 Cadillac V8, V12 and V16. 2 used per car on models 345C, 3555, 370, 452BC. 4 used on all other models. Cadillac part number 882679, group number 13.0216.



Material: Steel; Finish: Natural;
Length: 2.930; Width: 2.766;
Thickness: .056; Holes: .157 ID, 2.00
centers

Ghia Coachwork Hood Latch Spring

\$25.00

MISC-0197

Hood latch spring used with some Ghia bodied cars from the 1950's. This spring was produced for installation with a Ghia Supersonic body on an Aston Martin DB 2/4.



Material: Stainless steel; Finish:
Natural; Wire: .115; OD: 1.49; Free
length: 1.475

Ghia Coachwork Hood Support Spring

\$85.00

MISC-0208

Spiral torsion spring used as a hood support spring for cars with Ghia body coachwork. This spring was produced for the hood support on a Ghia Supersonic body on an Aston Martin DB 2/4.



Material: Steel; Finish: Natural; Width:
.300; OD: 2 11/16; Thickness: .078;
End loop ID: 11/32

Hood Door Spring, 1929-31 Packard

\$20.00
P-0126

Hood door spring for 1929-1931 Packard. 6-8 Springs required per car depending on model.

Packard part number 147283, "Bonnet Side Door Hinge Spring". For Packard Series 300 - 800.

OAL: 2 1/2; Wire size: .085; Loop OD: .357; "U" Length & width: 11/16 x .445



Packard Hood Louver Door Springs

\$13.75
Various Part Numbers

Right and left side hood louver door springs for 1938-39 Packard V-12.

Packard part numbers:
Right: 242118R, group 0.01901
Left: 242118L, group 0.01901.
6 Springs per side required.

Material: SS; Finish: Natural; Wire DIA: .072; OD: .395; LOB: 1.585; OAL: 7 1/4



Hood Door Spring, 1930-31 Cadillac & LaSalle

\$20.00
CAD-0082

Hood door spring for 1930-1931 Cadillac and LaSalle. For use on:

1930-1931 Cadillac: 355A V8; 370A V12; 452A V-16
1930-1931 LaSalle: 345A V8

One spring required for each hood door - total of 10 required per car. Cadillac group number 13.0316, part number 882235.

OAL: 3 1/2; Loop OD: 1/2; Wire size: .092; "U" Length & width: 1 1/32 x 13/16



Duesenberg J Hood Hook Eye Bolt Spring

\$7.00
J-7227

Duesenberg Model J hood hook eye bolt spring.

Material: Spring steel; Coils: 7; Wire size: .092; OD: .682; Free length: 1.630



Duesenberg J Hood Door Spring

\$8.50
J-7407

Duesenberg Model J hood door spring.

Material: Spring steel; Wire size: .108; OAL: 3.775; Hook ID x point to outside: .300, 1.75 wide, .740 center ID



Stutz Hood Vent Door Knob

\$18.00
STZ-0003

Steel knob for the hood vent door as used on Stutz SV-16 and DV-32. Quantity of 8 used per car.

Material: Cold rolled steel; Finish: Natural; Thread: 6-32; Thread length: .290; Head: .620 OD x .505 long; Length under head: .605; Step under head: .182 OD; OAL: 1.110



Stutz Hood Hinge End Plate

\$125.00
STZ-0006

Steel hood hinge end plate for Stutz DV-32. Used to hold the hinge pin to cowl and radiator.

Material: Steel; Finish: Natural; Length: 2.500; Width: .853; Height: .583; Holes: .312 ID, 1.776 center; Cut out: 1.080 x .140; Hood ID: .453



Cadillac V-8 V-16 Tail Light Conduit Hanger

\$31.50
Various Part Numbers

Steel strap to support spring type wiring conduit used on 1929-1930 V-8 and 1930-1931 V-16 Cadillac. May also be applicable to other years and models. Two sizes available. Cadillac group number 14.1995, part number 872298.

CAD-0063: Length: 6 1/4; Width at center: .650; Width at end: 1 1/8; Thickness: .035; Hole DIA: .342; Holes center to center: 5.130

CAD-0064: Length: 6 1/4; Width at center: .650; Width at end: 1 1/8; Thickness: .035; Hole DIA: .342; Holes center to center: 5.130



**Pyraline Lens for Tail Lights**\$30.00
J-6475-27

Dark red tinted plastic material.
Duplicate of color used in 1930's tail lamps.

Sold in a standard size of 9" x 4 1/2" x .030 thick for \$30.00. Can also be made to order in custom sizes up to 23" x 53" priced at \$.75 per square inch, rounded to the nearest inch. Contact us directly to order custom sizes.

**Cadillac Conduit for Rear Tail Light**\$15.00
CAD-0061

Conduit for rear tail lamp wiring on 1930-1931 Cadillac V-8 and V-12. Cadillac group number 14-1974, part number 1080556.

Material: Spring steel; Finish: Natural;
Length: 13 9/16; OD: 11/16; Wire: .080

**Maserati Ghibli Side Reflector Marker Light**\$110.00
MISC-0108

Maserati Ghibli side marker light produced from solid brass. This side marker is ready to be plated and is a replacement housing for the original plastic unit that cannot be plated. Fits some years of Maserati Ghibli, may also fit other models. Measures 2 13/16 OD. Specially produced for a Ghibli owner who wanted to replace his deteriorated original lights with a quality replacement.

**Stutz Tail Light Stanchion Fender Plate**\$67.50
STZ-0014, STZ-0015

Steel support plate for the tail light stanchion on Stutz M, SV-16 and DV-32. Attaches under the fender. Available in left and right side placement: STZ-0014 Left, STZ-0015 Right



Material: Steel; Finish: Natural;
Length: 3.785; Width: 2.445;
Thickness: .040; ID of bend: .500;
Holes: .343

License Plate Frame, Prewar Automobiles\$75.00
MISC-0178

Chrome plated adjustable license plate frame. Used on automobiles of the late 1930's and early 1940's.

OD: 7/16; Minimum width: 8.00;
Minimum height: 4.00

**Duesenberg A Left Side Engine Pan**\$125.00
A-3399-A

Duesenberg Model A left side engine dust pan. This new steel pan is a duplicate of the original design.

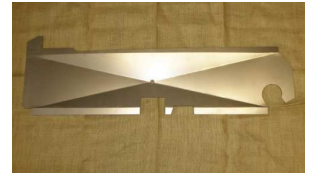
**Duesenberg A Right Side Engine Pan**\$150.00
A-3398-A

Duesenberg Model A right side engine dust pan. This new steel pan is a duplicate of the original design.

**Rolls Royce Phantom I II Bumper Center Spacer**\$125.00
RR-0004

Front and rear bumper spacer for use on Rolls Royce Phantom I and Phantom II Brewster bodied cars. Spacer fits between back bar and face bars where the center medallion attaches. CNC machined steel.

**Brewster Coachwork Front Seat Locating Socket**\$35.00
MISC-0214

Aluminum locating socket mounted to the body to prevent the seat from sliding. Used on Brewster bodied cars such as: Rolls Royce PI and P II. 2 used per seat. Original part number 17526.

OD: 1.946; Height: .182; Holes ID: .200; Center ID: .750



**Brewster Coachwork Front Seat Locating Pin**

\$35.00

MISC-0213

Aluminum pin mounting to the bottom of the seat to prevent it from sliding. Used on Brewster bodied cars such as: Rolls Royce PI and P II. Two used per seat. Original part number 17525.

Material: Aluminum; Base OD: 1.942; Base height: .162; Pin OD: .710; Pin height: .890; Holes OD: .182

**Duesenberg J Running Board Channel**

\$90.00

J-7328

Brass J-shape channel used to finish the inside edge of Duesenberg running boards. Can also be used as binding molding for a variety of vintage cars and boats.

Measures 72" long x 1.093 high x .032 thick.

**Stewart Warner Spotlight Mirror**

\$100.00

STW-0023-6

Glass mirror for use on Stewart Warner windshield mounted combination spotlight / rearview mirror. For use on Model A Duesenberg and possibly other cars of the era.

Material: Silvered glass; OD: 2.616; Thickness: .092

**Stewart Warner Spotlight Base**

\$90.00

STW-0023-1

Brass mounting base connecting to the support arm of a Stewart Warner spotlight. The spotlight mounts to the windshield and is a combination spotlight and rearview mirror. This is a CNC machined duplicate of the original part.

For use on Model A Duesenberg and possibly other cars of the era.

Base: 2.750 L x .875 W x .375 H; OAH: .9375; ID: .625; Screw holes: .208, 2.25 centers

**Stewart Warner Spotlight Faceted Nut**

\$50.00

STW-0023-3

Brass faceted nut securing the spotlight assembly to the support arm on Stewart Warner windshield mounted spotlight / rearview mirrors. For use on Duesenberg Model A and possibly other cars of the era.

Material: Brass; Finish: Natural; Thread: 1/4-24; Thread depth: .393; Hex: .750; Hex height: .240; OAH: .481; Step ID: .531

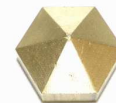
**Stewart Warner Spotlight Lens**

\$125.00

STW-0023-4

Glass lens for Stewart Warner windshield mounted combination spotlight / rearview mirror. For use on Model A Duesenberg and possibly other cars of the era.

OD: 3.916; Thickness: .092

**Stewart Warner Spotlight Support Arm**

\$375.00

STW-0023-2

Bronze support arm for a Stewart Warner windshield mounted combination spotlight / rear view mirror. This arm holds the light / mirror assembly and attaches to the mounting base. Recommended for use with our spotlight base (STW-0023-1) to ensure a snug fit. For use on Model A Duesenberg and possibly other cars of the era.

Material: Bronze; Width: 4.832; Height: 3.9375; ID between the arms: 4.300; Mounting stem hex: .623 x .550; ID on ends: .512

**Murphy Body Rear View Mirror Bracket Clamp Plate**

\$50.00

MB-0018

Bronze clamp plate used to hold the rear view mirror on the windshield of Murphy bodied cars.

Material: Bronze; Finish: Natural; Length: 2.032; Width: .375; Cut out ID: .562; Hole ID: .206; Hole centers: 1.453; Thickness: .064





Murphy Body Rear View Mirror Bracket

\$75.00

MB-0017

Rear view mirror windshield mounting bracket for the Beverly and other closed Murphy bodied cars. Can be adapted for use on a roadster.



Material: Bronze; Finish: Natural;
Thread: 10-24; OAL: 2.730; OAW:
2.410; Oval end: 2.410 x .750; Holes &
centers on oval: .215 ID x 1.625
centers; Cut out ID: .625; Holes &
centers for threaded holes: 1.453

Murphy Body Mirror Bracket Clamp Screw

\$25.00

MB-0018-1

Brass knurled screw used with the rear view mirror bracket & clamp on Murphy bodied cars.



Material: Brass; Finish: Natural;
Thread: 10-24; Thread length: .343;
OAL: .862; Length under head: .625;
Head OD: .585; Body OD: .375, .242
long