



Hobson KS Telegauge

\$220.00

MISC-0159

Hobson K-S Telegauge bezel and body. CNC machined duplicate of an original Hobson K-S Telegauge Fuel Gauge. For use on many American and English cars of the late 1920's and 1930's including the following: 1929 Bentley; 1930's Riley; 1929-31 Rolls Royce 20/25; 1927-29 Rolls Royce PI; 1929-35 Rolls Royce PII.



Bezel base: 3.960 L x 1.590 W; Bezel main: 3.750 L x 1.355 W; Bezel height: 1.500; Body: 3.550 L x 1.165 W x 1.750 H; Body slots: 2.230 L x .260 W

Hobson KS Telegauge Thin Lock Nut

\$20.00

MISC-0159-5

Thin brass hex nut for use as a locknut on the Hobson Telegauge. Specially threaded for use on the Hobson fluid reservoir.



Material: Brass; Finish: Natural;
Thread: 3/8-26; Hex: .500; Height: .130

Hobson KS Telegauge Fluid Reservoir

\$40.00

MISC-0159-4

Brass fluid reservoir for the Hobson KS Telegauge. The capillary tube attaches to the sight glass and solders to the bottom of this part. For use on many American and English car of the late 1920's and 1930's including:



1929 Bentley
1930's Riley
1929-31 Rolls Royce 20/25
1927-29 Rolls Royce PI
1929-35 Rolls Royce PII

Material: Brass; Finish: Natural;
Thread: 3/8-26; OAL: 2.405; ID: .233;
OD: .3750; Threaded length: 1.320;
Non-threaded length: 1.085

Hobson KS Telegauge End Cap Nut

\$37.50

MISC-0159-6

Brass hex nut used to retain the air line ferrule on the Hobson KS Telegauge fluid reservoir.



Material: Brass; Finish: Natural;
Thread: 3/8-26; Hex: .500; Hole in center: .192; Height: .375

Hobson KS Telegauge Reservoir Ferrule

\$15.25

MISC-0159-9

Brass ferrule for the airline at the fluid reservoir on Hobson KS Telegauge.



Material: Brass; Finish: Natural; OAL: .520; Shaft: .185 OD x .300; Head: .310 to .210 OD, .220 long; ID: .080 to .053

Hobson KS Telegauge Sight Glass

\$125.00

MISC-0159-3

Straight sight glass tube for use on Hobson KS Telegauge. For use on many European cars of the late 1920's and 1930's including the following:



1929 Bentley
1930's Riley
1929-31 Rolls Royce 20/25
1927-29 Rolls Royce PI
1929-35 Rolls Royce PII

Material: Copper, glass; Finish: Natural; Glass OD: .233; Glass length: 2.981; Wire OD: .077; Wire length: 5.312 (approx.)

King Seeley Fuel Gauge Body & Bezel, 1925 Flint

\$255.00

KS-0016

King Seeley fuel gauge body and bezel for 1925 Flint Model E-55. Aluminum gauge body and bronze bezel are CNC machined duplicates of the originals. Body and bezel fit perfectly.



Gauge body - Finish: Natural; OAL: 3.00; Base height: .470; OAH: 1 3/4



King Seeley Fuel Gauge Body, 1928 Pontiac

\$150.00
KS-0012

King Seeley gauge body for 1928 Pontiac, may also fit other years and models of automobiles. Fully machined cadmium plated bronze casting, perfect reproduction. This style of King Seeley housing does not have illumination cutouts.



Base/Body DIA: 2.150, 1.950; Length: 2.850; Height: .690

King Seeley Fuel Gauge Body for 1929 REO

\$150.00
KS-0022

King Seeley fuel gauge body as used on 1929 REO, may also fit other years and makes of automobiles. This is a CNC machined duplicate of the original part.



Material: Aluminum; Finish: Natural;
ID: 1.758 x 2.910; Length: 3.050;
Width: 1.920; Height: 1.800; Hole ID through body: .312; Hex hole: .335

King Seeley Fuel Gauge Body, Auburn

\$150.00
KS-0021

King Seeley fuel gauge body as used on 1929 Auburn 8-90 Speedster. This is a CNC machined duplicate of the original part.



Material: Aluminum; Base: 2.817 x 2.785; Height to top and body: 1.5 and .585; Body height x OD: 7/16 x 1.902; ID: 1.765; Mounting holes: 5/32, 2.2 centers

King Seeley Fuel Gauge Body, 1929 Pontiac

\$150.00
KS-0011

King Seeley fuel gauge body to fit 1929 Pontiac, may also fit other years and models of automobiles. Fully machined cadmium plated bronze casting, perfect reproduction. Has two illumination cutouts on the right hand side and two ears to hold gauge into dash.



Base/Body DIA: 2 3/16, 1 15/16;
Length: 2 7/8; ID: 1 7/8

King Seeley Fuel Gauge Body for 1927 Oldsmobile

\$150.00
KS-0023

CNC machined aluminum fuel gauge body for use on 1927 Oldsmobile.



Material: Aluminum; Finish: Natural;
Length: 2.906; Height: .662; OD body, base: 1.875, 2.140; ID body: 1.768; ID holes in ends: .345

King Seeley Fuel Gauge Bozel for 1927 Packard

\$75.00
KS-0024-1

CNC machined aluminum fuel gauge bezel for use with our gauge body for 1927 Packard Series 400, our part number KS-0024.



Material: Aluminum; Finish: Natural;
OD: 2.294; ID: 1.210 x 1.880; Holes: .127; Hole centers: 1.903; Thickness of base: .072; OAH: .242

King Seeley Fuel Gauge Body for 1927 Packard

\$150.00
KS-0024

CNC cut aluminum fuel gauge body for 1927 Packard Series 400. For use with our bezel, part number KS-0024-1.



Material: Aluminum; Finish: Natural;
Body: 2.175 OD, 2.920 long, .605 high; OAH: 1.850; ID underside: 2.062; ID holes on ends: .342

King Seeley Fuel Gauge Body, Franklin & Nash

\$150.00
KS-0015

King Seeley fuel gauge body. This gauge body is a CNC machined duplicate of the original part. For use with all Franklins 1929-1933 and 1929 Nash 464 - may also fit other years and models of Nash.



Material: Aluminum; Finish: Natural;
Body ID: 1 7/8; Base OD: 2.00; OAH: 9/16; OAL: 1 13/16; Attachment hole ID: 3/16

King Seeley Fuel Gauge Body, 1932 Packard

\$150.00
KS-0020

King Seeley fuel gauge body for use on 1932 Packard and others - illumination cutouts have been machined on both sides for wider automobile application. CNC machined duplicate of an original part. Packard part number 186877.



Material: Aluminum; Finish: Natural;
Base: 2.907 x 2.038; Body OD: 2.038;
Body ID: 1.975; Illumination cutout:
1/8 x .930; Height: 1.700

King Seeley Fuel Gauge Body, Packard

\$150.00
KS-0010

King Seeley fuel gauge body for Packard and other makes. Fully machined cadmium plated bronze casting, perfect reproduction.



Base: Width: 2.045; Length: 2.906;
Height: 0.115

Body: Width: 2.045 (OD); Length:
2.828; Height: 0.484

Square Ends: Length: 0.430, 0.410;
Width: 0.500, 0.500; Height: 0.470,
0.420; ID: 0.3125

Slots (2): 1.015 x 0.120

Tab: Width: 0.742; Thickness: .205;
Height: 1.100; Hex Hole: 0.330

King Seeley Fuel Gauge Body, 1928 Studebaker

\$150.00
KS-0018

King Seeley fuel gauge body for 1928 Studebaker, may also fit other years. This is a CNC machined duplicate of the original gauge body.

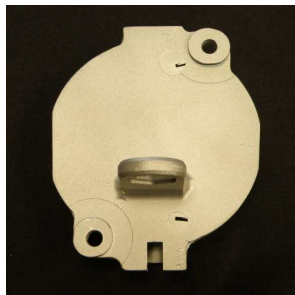

Material: Aluminum; Finish: Natural;
Bottom OD/ID: 2.394 / 2.275; Top OD:
2.664; Base Height: .708; Tab: .755 x
1.225; Hex on tab: .345

King Seeley Fuel Gauge Repair Kit

\$40.00
J-5609

Gauge repair kit contains 15ft of capillary tube, two ferrules and line nuts, one vial of red gauge fluid and printed installation instructions. This kit will replace the capillary tube between the gas gauge and the tank unit.



King Seeley Fuel Gauge Sight Glass Assembly

\$130.00

Part number varies

New reservoir and sight glass ready for installation in your housing. Fits most gauge bodies using a straight sight tube. Two reservoir lengths available: 2 3/4 or 3 1/4.



King Seeley Fuel Gauge Sight Glass and Tube

\$85.00

KS-0001

This straight glass sight tube will fit most King Seeley gauges. Installing a new glass and tube insures the gauge will work. Most gauge problems are due to blockage of this capillary tube.

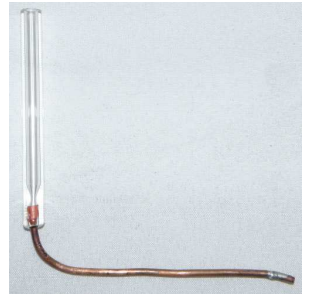

King Seeley Fuel Gauge Reservoir

Varies

Varies

Brass reservoir for the sight gauge. The capillary tube attaches to the sight glass and solders to the bottom of this part. The top is machined with one thread Dia. for the mounting nuts which hold the reservoir on the back of the gauge body. The other Dia. is for the special King Seeley line nut and ferrule.



Two lengths available:
KS-0005: 2 3/4, \$42.00
KS-0004: 3 1/4, \$45.00



King Seeley Fuel Gauge Reservoir Retaining Nut

\$4.50

J-5604-3

Cadmium plated steel hex nut to hold the reservoir to the gauge housing.



King Seeley Fuel Gauge Red Fluid

\$18.00

J-5606-2

Gravity specific red fluid for King Seeley gas gauges. Sold by the vial. Fluid has good color stability.



King Seeley Fuel Gauge Capillary Tube Ferrule

\$3.50

KS-0002

Tapered brass ferrules for the ends of the capillary tube. These are designed to be soldered to the end of .083 OD copper tubing. This is a special design to seal to the sight gauge reservoir and sending unit. 2 required per gauge.



King Seeley Fuel Gauge Rebuilding Service

Varies

Classic and Exotic Service, Inc. has the experience and inventory to rebuild the King Seeley Fluid Gauge units as used on Lincoln, Studebaker, Auburn, Packard, Duesenberg, Pierce Arrow and others.

Our rebuilding service includes:

- *Disassembly, cleaning, and replacement of parts as needed
- * Components are carefully assembled and checked before shipment
- * Finished units are ready to be installed on your chassis



2" Glass Instrument Lens Support Plate

\$9.00

J-5671

.020 thick steel disk which fits between a 2" Dia beveled glass lens and the instrument case.

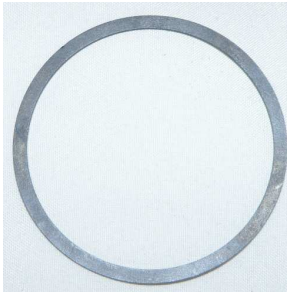

This service takes approximately 3 weeks to complete. Price is dependent upon condition. For more information: call 1-248-362-2097 Monday thru Friday 8AM - 5PM EST or email Parts@classicandexotic.com.

King Seeley Fuel Gauge Sending Unit Adapter

\$8.00

KS-0003

Brass adapter, the un-threaded end is soldered to the tube coming out of the gas tank sending unit. The other end is threaded to fit the special King Seeley line nut and ferrule. Used to repair sending units where the original adapter is cracked.



King Seeley Fuel Gauge Sending Unit Fuel Line End

\$7.50

KS-0013

King Seeley fuel gauge sending unit fuel line end. Solders on to 1/4 fuel line coming out of the sending unit. Has 1/2" hex with 7/16-20 thread and 1/4 ID to fit over the fuel line.

